

EP

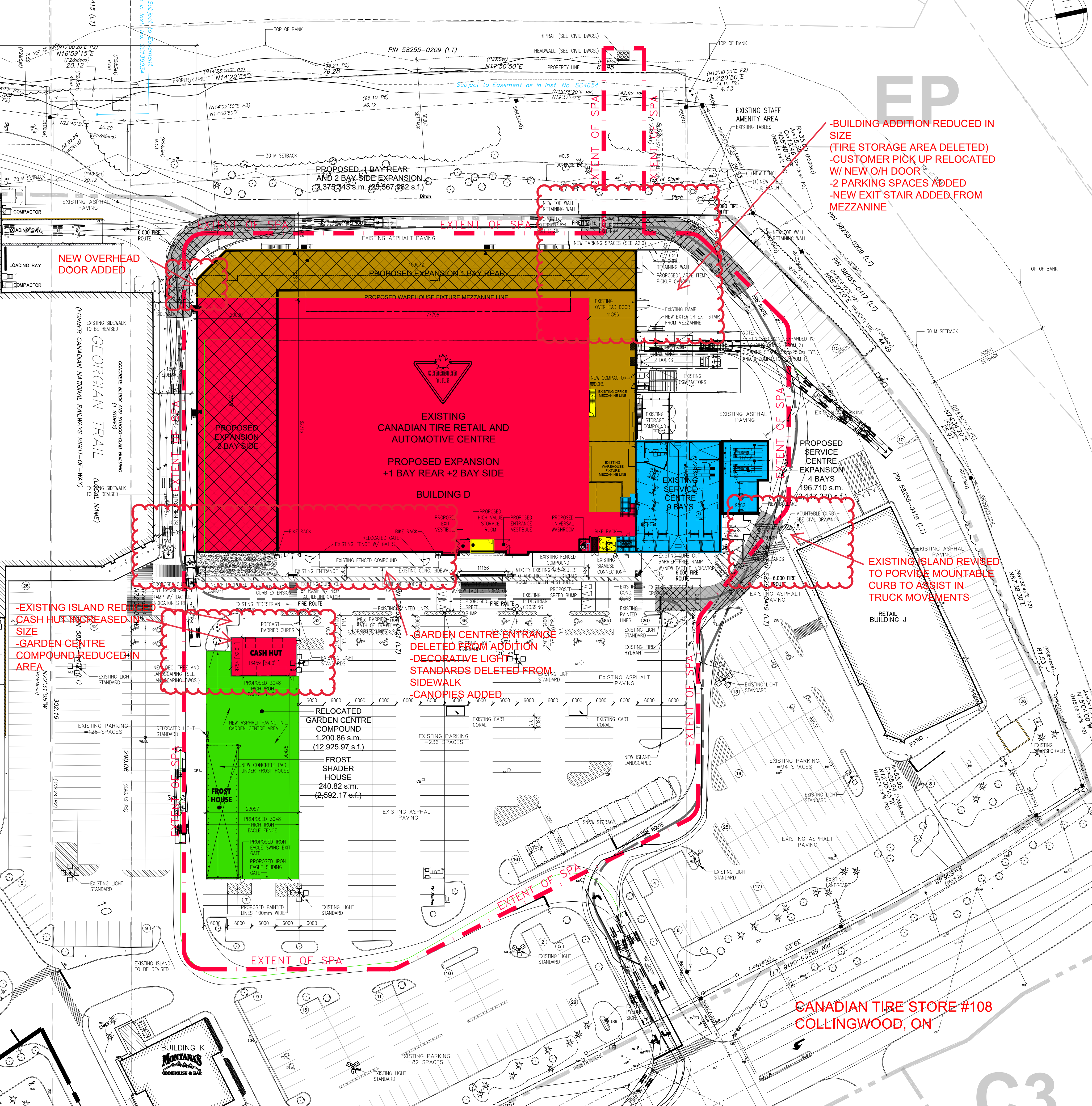

-BUILDING ADDITION REDUCED IN SIZE
 (TIRE STORAGE AREA DELETED)
 -CUSTOMER PICK UP RELOCATED W/ NEW O/H DOOR
 -2 PARKING SPACES ADDED
 -NEW EXIT STAIR ADDED FROM MEZZANINE

NEW OVERHEAD DOOR ADDED

EXISTING ISLAND REVISED TO PORVISE MOUNTABLE CURB TO ASSIST IN TRUCK MOVEMENTS

-EXISTING ISLAND REDUCED
 CASH HUT INCREASED IN SIZE
 -GARDEN CENTRE COMPOUND REDUCED IN AREA

-GARDEN CENTRE ENTRANCE DELETED FROM ADDITION
 -DECORATIVE LIGHT STANDARDS DELETED FROM SIDEWALK
 -CANOPIES ADDED

CANADIAN TIRE STORE #108
 COLLINGWOOD, ON

PROPOSED 1 BAY REAR AND 2 BAY SIDE EXPANSION
 2,375.343 s.m. (25,567,982 s.f.)

EXISTING CANADIAN TIRE RETAIL AND AUTOMOTIVE CENTRE

PROPOSED EXPANSION +1 BAY REAR +2 BAY SIDE

BUILDING D

PROPOSED SERVICE CENTRE EXPANSION 4 BAYS
 196,710 s.m. (2,147,370 s.f.)

EXISTING SERVICE CENTRE 9 BAYS

RELOCATED GARDEN CENTRE COMPOUND
 1,200.86 s.m. (12,925.97 s.f.)

FROST SHADER HOUSE
 240.82 s.m. (2,592.17 s.f.)

CASH HUT
 164.59 [54.0']

FROST HOUSE
 230.57

BUILDING K
 MONTANA'S
 COOKHOUSE & BAR