

MONITORING GRAPHS & DATA

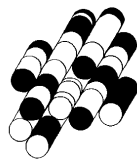

Terraprobe Inc.

Terraprobe -- 31-14-1099
 Balmoral Development, Collingwood

Monitoring/ Borehole Location	Ground Surface Elevation (m)	Static Water Level Depth Below Existing Ground Surface (m)									
		4-Dec-14	10-Dec-14	6-Jan-15	12-Feb-15	5-Mar-15	20-Apr-15	12-May-15	8-Jun-15		
201	179.5		-0.4	-0.2			-0.2	-0.5	-0.5		
202	178.8	-1.2	-0.7	-0.5	-1.2	-1.5	-0.3	-0.8	-1.4		
203	178.6	-1.2	-0.5	-0.3	-0.9	-1.4	-0.2	-0.4	-1.4		
204	179.0	-1.5	-1.0	-0.9	-1.5	-1.5	-0.8	-1.0	-1.3		
205	178.9	-1.3	-1.2	-1.0	-1.4	-1.6	-1.1	-1.3	-1.7		
206	178.7	-0.9	-0.2	-0.1	-0.4	-0.7	-0.1	-0.2	-1.2		
207	179.1	-1.2	-0.4	-0.3	-0.7	-0.9	-0.3	-0.5	-1.3		
208	180.1	-0.9	-1.5	-1.3	-1.6	-1.8	-1.2	-1.4	-2.0		
209	179.2		-0.2	-0.2	-0.2	-0.2	-0.2	-0.3	-0.6		
210	178.6	-1.2	-0.2	-0.1	-0.2	-0.2	-0.1	-0.1	-0.7		
211	178.6	-1.2	-0.5	-0.4	-0.6	-0.9	-0.3	-0.5	-1.5		
212	179.2	-1.8	-1.0	-1.2	-1.4	-1.7	-1.2	-1.3	-2.2		

noted

BH1 frozen

Monitoring/ Borehole Location	Ground Surface Elevation (m)	Static Water Level Elevation (m)									
		4-Dec-14	10-Dec-14	6-Jan-15	12-Feb-15	5-Mar-15	20-Apr-15	12-May-15	8-Jun-15		
201	179.5		179.1	179.3			179.3	179.0	179.0		
202	178.8	177.6	178.1	178.3	177.6	177.3	178.5	178.0	177.4		
203	178.6	177.4	178.2	178.3	177.7	177.2	178.4	178.2	177.2		
204	179.0	177.5	178.0	178.1	177.5	177.5	178.2	178.0	177.7		
205	178.9	177.6	177.8	178.0	177.5	177.3	177.8	177.6	177.2		
206	178.7	177.8	178.5	178.6	178.3	178.0	178.6	178.5	177.5		
207	179.1	177.9	178.7	178.8	178.4	178.2	178.8	178.7	177.8		
208	180.1	179.2	178.7	178.8	178.5	178.3	178.9	178.7	178.1		
209	179.2		179.0	179.0	179.0	179.0	179.0	179.0	178.6		
210	178.6	177.4	178.4	178.5	178.4	178.4	178.5	178.5	177.9		
211	178.6	177.4	178.1	178.2	178.0	177.7	178.3	178.1	177.1		
212	179.2	177.4	178.2	178.0	177.8	177.6	178.0	177.9	177.1		

noted

**Static Groundwater Level Monitoring
Balmoral Development -- Collingwood
Terraprobe -- 31-14-1099**

Depth Below Ground Surface (m)

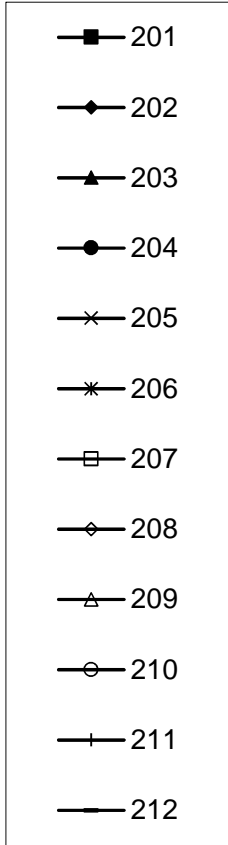
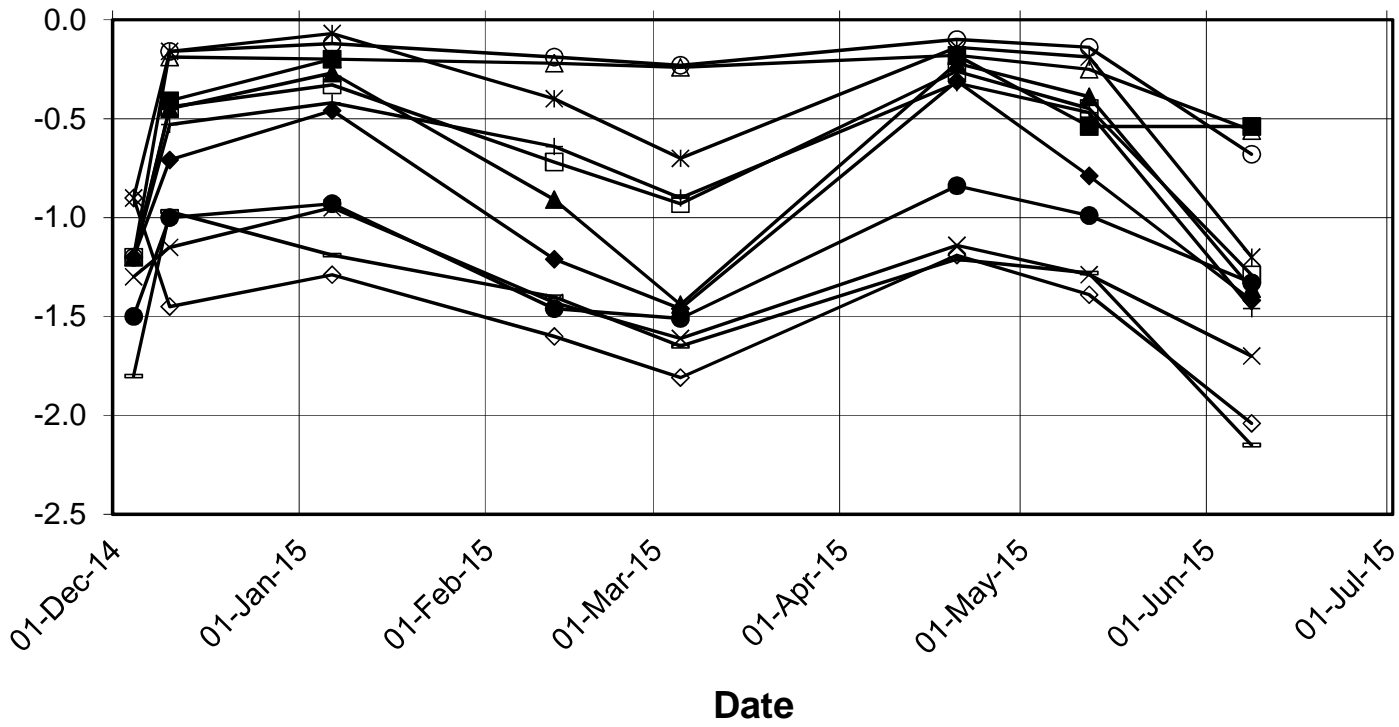

Static Groundwater Level Monitoring Balmoral Development -- Collingwood Terraprobe -- 31-14-1099

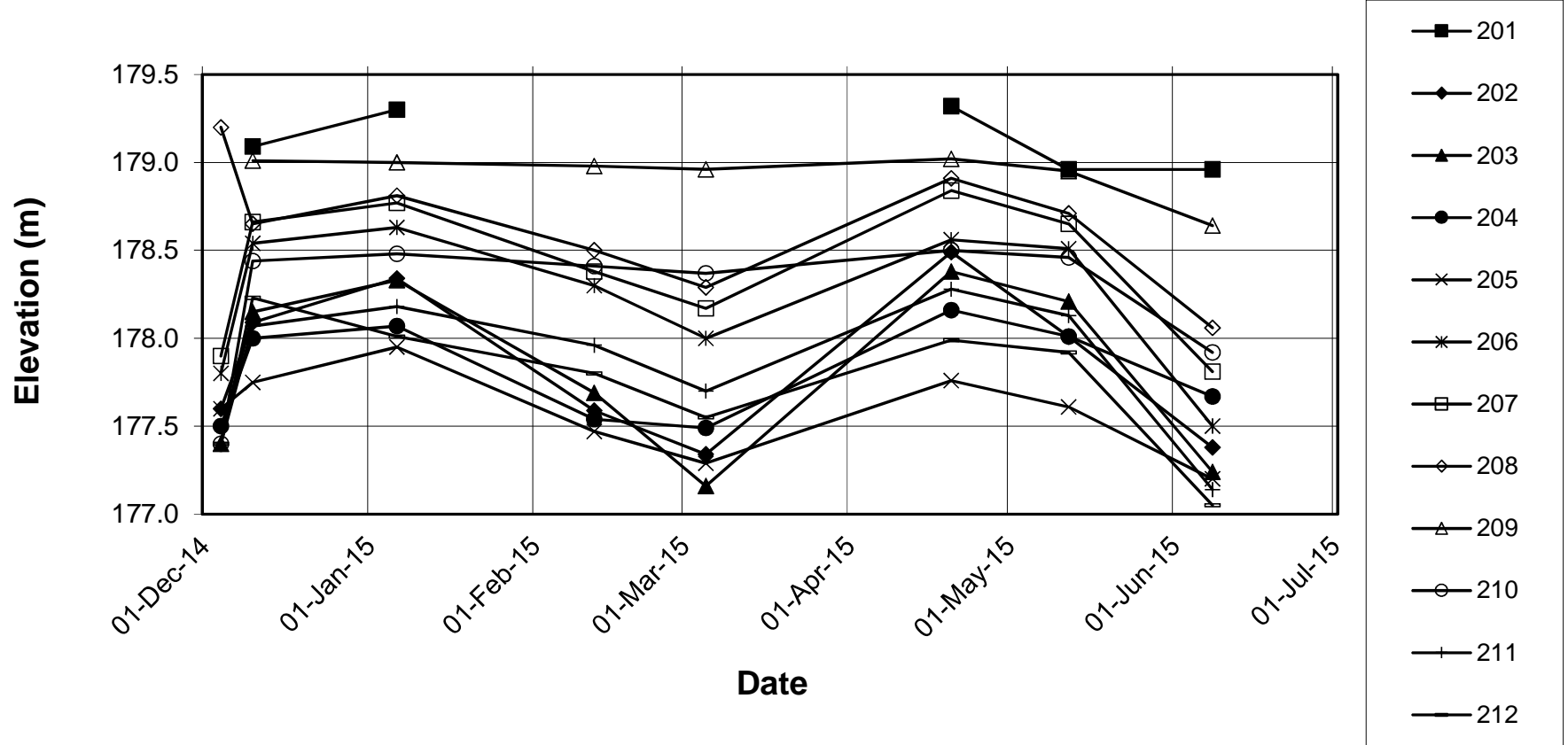

FIGURES

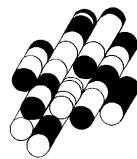

Terraprobe Inc.



DECEMBER 2014

SITE LOCATION PLAN

31-14-1099



DECEMBER 2014

BOREHOLE LOCATION PLAN

31-14-1099



FIGURE 2

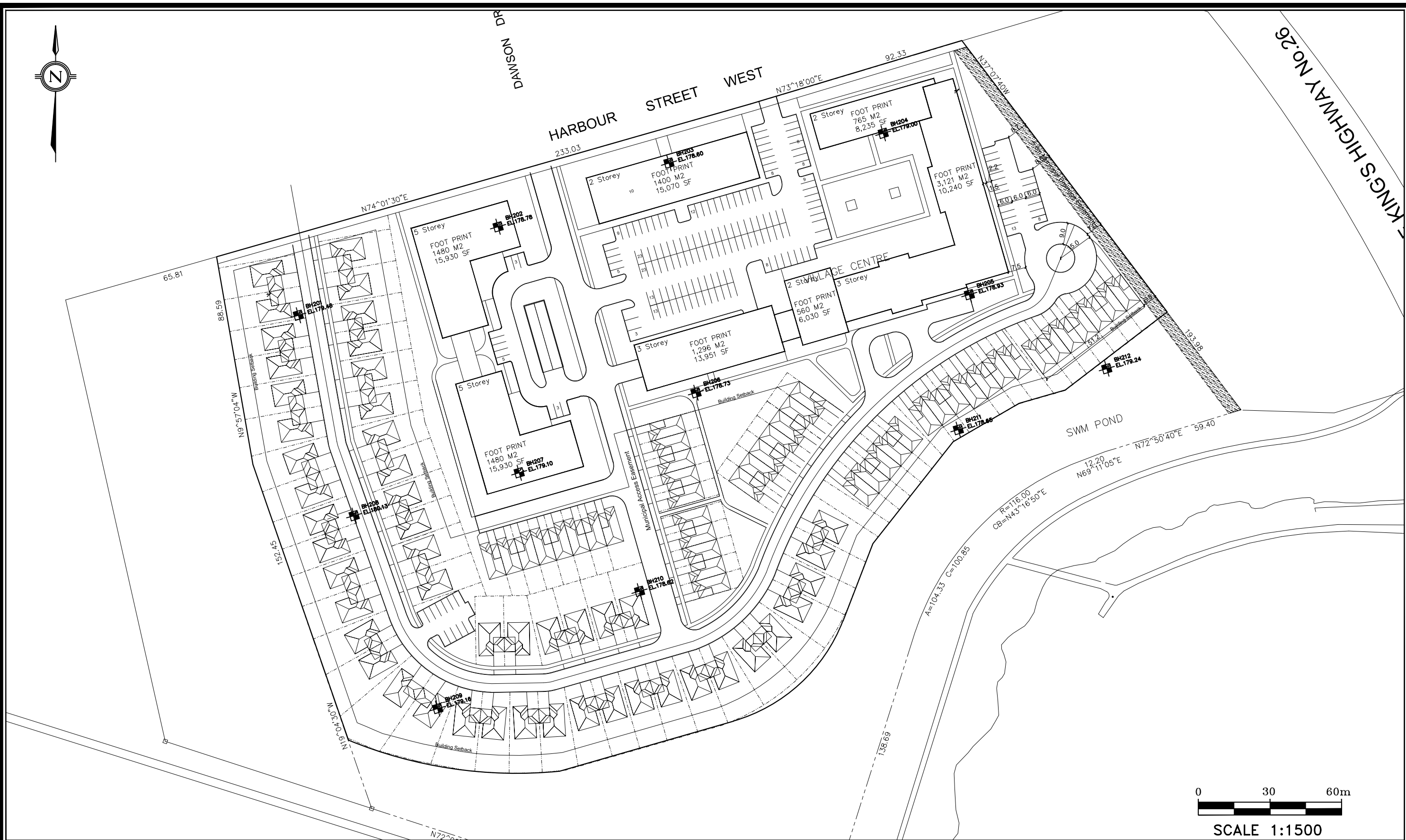

DECEMBER 2014

BOREHOLE LOCATION PLAN

33-14-1099



FIGURE 3